

Township 7 South

Range 42 East W 16

Union County, Oregon.

Albert Wright of Lamm Fisher March 26 1888

I commenced at the 1/4 sec corner
bet Sec 7 & 12 on Range line bet Range 41 & 42
thence East through Sec 7 var 20°

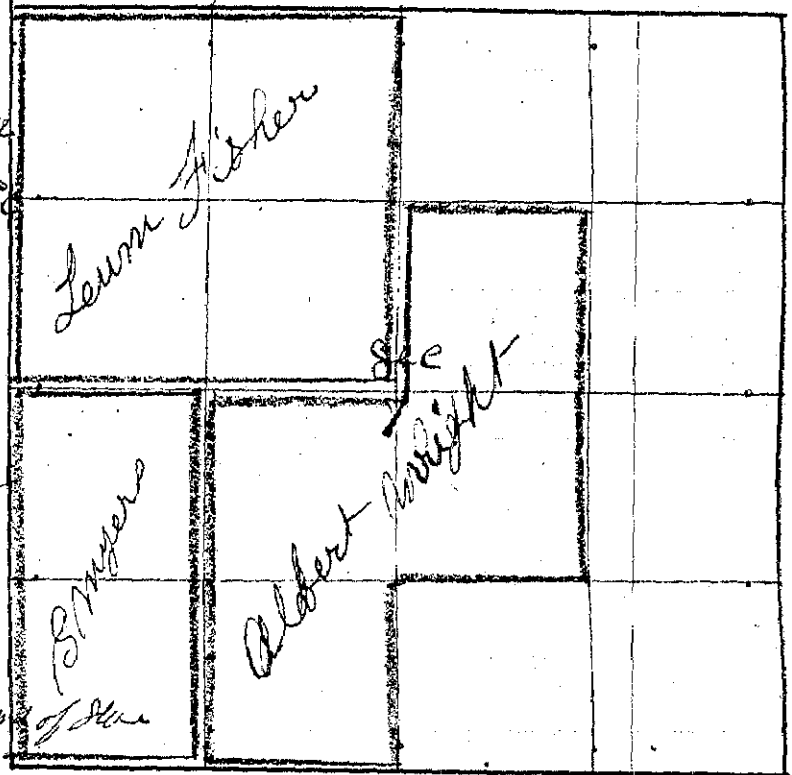

20 50 Set temporary 1/16 corner
40 50 Set temporary center Sec 7
60 50 Set temporary 1/16 corner
80 30 Intersect East Bdy at 1/4 sec cor bet Sec 7 & 8
thence North var 20° E

20 50 Set temporary 1/8 cor
40 28 the corner to Sec 5 = 6 = 7 & 8 stone in mound of stone
thence South

20 14 Set Post for 1/8 cor
40 28 the 1/4 sec corner bet Sec 7 & 8
The corner to Sec 5 = 6 = 7 & 8
thence West var 21° E

40 48 the 1/4 sec corner bet Sec 6 & 7 a stone in mound of stone
thence South through Sec 7 var 20° E

20 50 Set temporary 1/16 corner
80 28 Intersect E & W line 45 lks west of temporary stake

55 60 Set temporary 1/16 corner
80 77 Intersect South Boundary 25 lks west of 1/4 sec cor bet Sec 7 & 8
thence North 11' W on true line

20 19 Set Post for 1/16 cor in center S 1/2 Sec 7
40 34 Set Post in mound of stone for center Sec 7
60 58 Set Post for 1/16 corner in center N 1/2 Sec 7
thence East

20 45 Set Post for 1/16 cor in center N E 1/4 Sec 7
thence South

20 15 Set Post for center E 1/2 Sec 7 in mound of stone
The center Sec 7
thence West

20 50 Set Post for 1/16 cor in center W 1/2 Sec 7
The 1/4 sec corner bet Sec 7 & 12
thence West var 21° E

20 50 Set temporary 1/8 cor
39 65 Intersect 25 lks South of corner to Sec 7 = 12 = 12 & 18
S 89° 48' E on true line

17 57 Set Stone 6 x 10 x 20 for 1/8 cor
J. W. Lambell Deputy County Surveyor