

Township 6 South

Range 38 East W.M.

Union County, Oregon.

Alvion Frisby

April the 16 1888

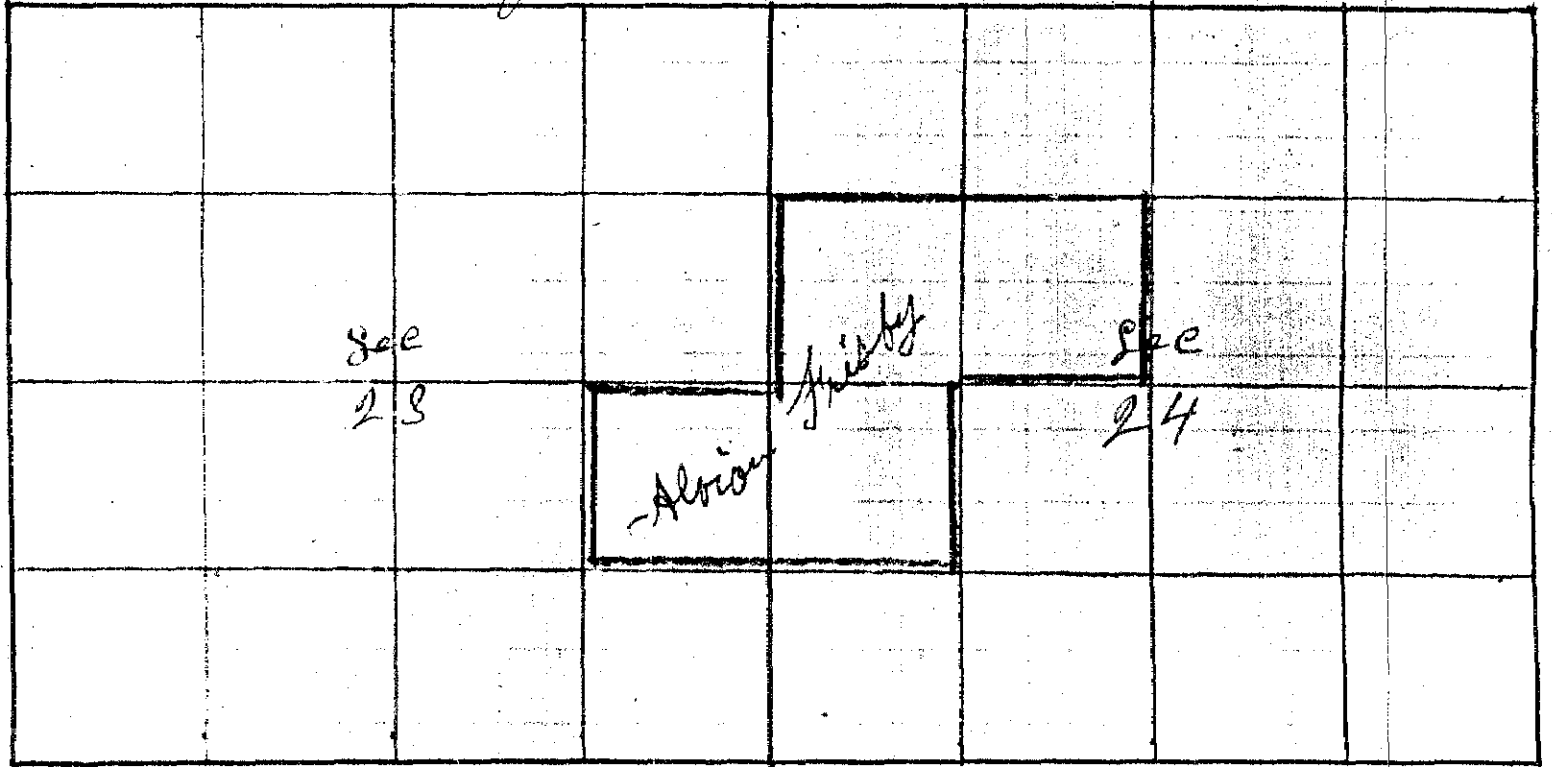

Commenced at the corner to Sec 13=14=23 & 24
 a Post in Mound of Earth thence East bet Sec 13 & 24
 Var 20° 15' E

- 40 11 found No 1/4 Sec corner Set temporary 1/4 Sec. Post
- 81 50 Intersect East boundary at the corner to Sec 13=24 & 18 & 19
 thence West
- 40 90 Set Post for 1/4 Sec corner dug pits N & S built mound of Earth
- 67 35 Set Post for 1/8 corner
- 81 80 The corner to Sec 13=14=23 & 24
 thence South bet Sec 23 & 24 Var 20° E
- 40 23 The 1/4 Sec corner bet Sec 23 & 24 Post in Mid of Earth
 thence North
- 20 11 1/2 Set Post for 1/8 cor in Mound of Stone
 The 1/4 Sec corner bet Sec 23 & 24
 thence East through Sec 24 Var 20° E
- 20 50 Set temporary 1/16 cor
- 40 20 Set temporary center Sec 24
- 81 60 The 1/4 Sec corner bet Sec 24 & 19
 The corner to Sec 24=25=19 & 30
 thence west-
- 39 80 found No 1/4 Sec corner Set temporary 1/4 Sec
- 81 58 The corner to Sec 23=24=25 & 26
 thence East-
- 40 79 Set Post built mound of Earth dug pits N & S for 1/4 Sec
 thence North through Sec 24
- 110 07 Intersect E & W line at temporary center
- 80 14 The 1/4 Sec corner bet Sec 13 & 24 thence South
- 20 03 1/2 Set Post for 1/16 cor in center N 1/4 Sec 24

W. H. Kimball Deputy Co. Surveyor