

CHAINS. LKS.

J. L. Rose Thos. Gilliam Neville Bros. & Oliver Bros. Oct. 7 1889

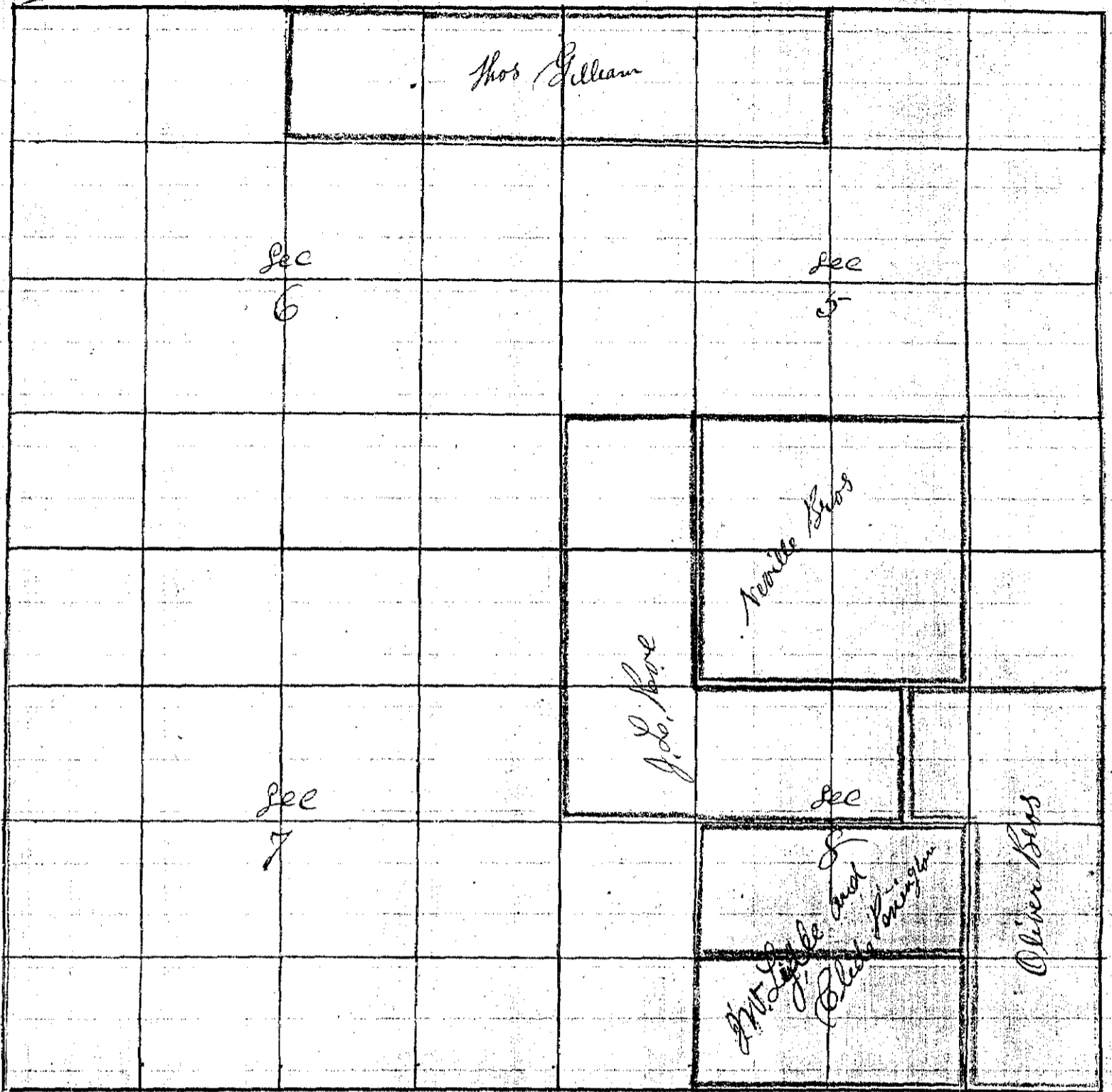

I Commenced at The Corner to Sec 5-6-81 & 82
 on the Township line set 1/4 Sec 1 & 2 South
 Thence South set Sec 5 & 6
 Var 19° 45' E

- 14 55 Set Temporary 1/8 corner
- 39 55 found no 1/4 Sec cor Set Temporary 1/4 Sec cor
- 59 55 Set Temporary 1/8 corner
- 79 58 Intersect 17 lks west of corner to Sec 5-6-7 & 8
 Thence N 7° W on True line
- 1320⁶⁶ 20 01 Set Stone 6 x 8 x 18 for 1/8 cor
- 2601³² 40 02 Set Stone 5 x 18 x 25 for 1/4 Sec cor set Sec 5 & 6
- 3961⁹⁸ 60 08 Set Stone 5 x 14 x 28 for 1/8 corner

The corner to Sec 5-6-7 & 8
 Thence west set Sec 6 & 7
 Var 20° 30' E

- 40 00 found no 1/4 Sec cor Set Temporary 1/4 Sec corner
- 78 82 Intersect west boundary at corner to Sec 6-7-1 & 2

CHAINS.	LINKS.	
		Hence East bet Sec 6 & 7
38	61	Set Post for 1/4 Sec corner bet Sec 6 & 7
78	82	The corner for Sec 5-6-7 & 8 Hence East bet Sec 5 & 8 Var $20^{\circ} 45' E$
19	97 1/2	Set Temporary 1/8 corner
39	95	found no 1/4 Sec corner Set Temporary 1/4 Sec corner
59	92 1/2	Set Temporary 1/8 corner
80	59	Intersect 61 links North of corner to Sec 4-5-8 & 9 Hence $N 89^{\circ} 34' W$ on June line
20	15	Set Stake for 1/8 corner
40	30	Set Stake for 1/4 Sec corner bet Sec 5 & 8
60	44	Set Stone 5 x 8 x 22 for 1/8 corner
80	59	The corner for Sec 5-6-7 & 8 The corner for Sec 4-5-8 & 9 Hence North bet Sec 4 & 5 Var $20^{\circ} 30' E$
20	00	Set Temporary 1/8 corner
40	00	found no 1/4 Sec corner Set Temporary 1/4 Sec corner
60	00	Set Temporary 1/8 corner
79	67	Intersect North Boundary 100 links West of the corner to Sec 4-5-8 & 9 Hence $S 43^{\circ} W$ on June line
19	64	Set 1/8 corner Post
39	58	Set 1/4 Sec corner Post
59	63	Set 1/8 corner Post
79	67	The corner for Sec 4-5-8 & 9 The corner for Sec 4-5-8 & 9 on Township's line bet T 1 & 2 South Hence West bet Sec 5 & 8 Var $20^{\circ} E$
40	00	Set Temporary 1/4 Sec corner
80	18	The corner for Sec 5-6-8 & 9 Hence East bet Sec 5 & 8
40	09	Set Stone 8 x 12 x 32 for 1/4 Sec corner bet Sec 5 & 8
80	18	The corner for Sec 4-5-8 & 9 The 1/4 Sec corner bet Sec 4 & 5 Hence West

Hence west through center Sec 5
 (Var 20° E)

- 20 50 Set Temporary 1/6 corner
- 40 50 Set Temporary center Sec 5-
- 60 50 Set Temporary 1/6 corner
- 80 43 Intersect at the 1/4 Sec corner bet Sec 5 & 6

Hence East through Sec 5-

- 20 10 Set Stake for 1/6 corner in center W 1/2 Sec 5-
- 40 22 The center Sec 5-
- 60 82 The 1/6 corner in center E 1/2 Sec 5-
- 80 48 The 1/4 Sec corner bet Sec 4 & 5-

The 1/4 Sec corner bet Sec 5 & 32.

Hence South through Sec 5-

(Var 20° 15' E)

- 19 60 Set Temporary 1/6 corner
- 39 60 Set Temporary center Sec 5-
- 59 60 Set Temporary 1/6 corner
- 79 68 Intersect 15. lks East of 1/4 Sec corner bet Sec 5 & 8

Hence North through Sec 5-

- 20 02 Set Post for 1/6 corner in center S 1/2 Sec 5-
- 40 04 Set Post for center Sec 5-
- 60 06 Set Stone 9x10x24 for 1/6 corner in center N 1/2 Sec 5-
- 79 68 The 1/4 Sec corner bet Sec 5 & 32

The 1/8 corner on West Boundary N W 1/4 Sec 5-

Hence East through N 1/2 Sec 5-

- 20 00 fence N & S
- 40 14 The 1/6 corner in center N 1/2 Sec 5-
- 80 29 The 1/8 corner on East Body, N E 1/4 Sec 5-

The 1/8 corner on West Boundary S W 1/4 Sec 5-

Hence East through S 1/2 Sec 5-

- 40 28 The 1/6 corner in center S 1/2 Sec 5-

Hence West through S W 1/4

- 20 11 Set Stone 8x14x20 for 1/6 corner in center S W 1/4 Sec 5-

The center S 1/2 Sec 5-

Hence East through S E 1/4

- 40 26 The 1/8 corner on East Body S E 1/4 Hence West
- 20 13 Set Stone 9x11x24 for 1/6 corner in center S E 1/4 Sec 5-

CHAINS.
LKS.

The 1/8 corner on South Bdy of E 1/4 Sec 5 -
Thence North through S E 1/4 Sec 5 -

20 04 The center S E 1/4 Sec 5 -

40 08 The center E 1/2 Sec 5 -

The 1/4 Sec corner bet Sec 6 & 7 on Range line
bet Ranges 38 & 39

Thence South bet Sec 6 & 7
Var 20° E

40 12 The corner to Sec 6 = 7 = 12 & 12

Thence South bet Sec 7 & 12
Var 20° E

80 24 The corner to Sec 7 = 12 = 12 & 13

Thence North

40 12 Set post for 1/4 Sec corner bet Sec 7 & 12

The 1/4 Sec corner bet Sec 5 & 6

Thence West through Sec 6
Var 20° 15' E

40 00 Set Temporary center Sec 6

79 31 Intersect West Boundary 29 lks North of 1/4 Sec cor bet Sec 6
Thence N 89° 47' E on True line through Sec 6

The 1/4 Sec corner bet Sec 6 & 7

Thence North through Sec 6
Var 20° E

40 08 Intersect E & W line

60 00 Set Temporary 1/16 corner

79 78 Intersect North Boundary 12 lks West of 1/4 Sec cor
bet Sec 6 & 31
Thence South

19 70 Set Stone 4 x 18 x 24 for 1/16 cor in Center N 1/2 Sec 6

39 70 The center Sec 6

The corner to Sec 5 = 6 = 7 & 8

Thence South bet Sec 7 & 8
Var 20° 15' E

40 00 found no 1/4 Sec corner Set Temporary 1/4 Sec cor

80 00 Set Temporary corner to Sec 7 = 8 = 17 & 18 -

Thence South bet Sec 17 & 18

40 44 The 1/4 Sec corner bet Sec 17 & 18

CHAINS.	LEGS.	
		Hence North set Sec 17 & 18
40	14	Set Post for corner to Sec 7-8-17 & 18 Hence North set Sec 7 & 8
40	15	Set Stone 8 x 12 x 24 for 1/4 Sec cor set Sec 7 & 8
80	30	The corner to Sec 5-6-7 & 8 The corner to Sec 4-5-8 & 9 Hence South set Sec 8 & 9 Var 20° E
20	50	Set Temporary 1/8 cor
40	50	Set Temporary 1/4 Sec cor
60	50	Set Temporary 1/8 cor
80	28	The corner to Sec 8-9-16 & 17 Hence North set Sec 8 & 9
40	57	Set Stone 4 x 12 x 24 for 1/8 cor
40	14	Set Stone 6 x 9 x 20 for 1/4 Sec cor set Sec 8 & 9
60	21	Set Stone 8 x 8 x 19 for 1/8 cor
80	28	The corner to Sec 4-5-8 & 9 The 1/4 Sec Corner set Sec 7 & 8 Hence East through Sec 8 Var 20° E
20	00	Set Temporary 1/16 corner
40	00	Set Temporary center Sec 8
52	00	Set Temporary Fractional cor set Oliver & Rose
60	00	Set Temporary 1/16 corner
80	20	Intersect East Boundary 8 1/2 m North of 1/4 Sec cor set Sec 8 & 9 Hence N 89° 56' W on True line
20	08	Set Stone 7 x 9 x 20 for 1/16 corner in center E 1/4 Sec 8
28	11	Set Stone 6 x 10 x 21 for Fractional corner set Oliver & Rose
40	16	Set Stone 6 x 12 x 18 for center Sec 8
60	24	Set Stone 8 x 7 x 27 for 1/16 corner in center W 1/4 Sec 8
80	33	The 1/4 Sec cor set Sec 7 & 8 The 1/4 Sec cor set Sec 8 & 17 Hence North through Sec 8 Var 20° 15' E
20	00	Set Temporary 1/16 cor
40	17	Intersect E & W line 12 m East of center
60	17	Set Temporary 1/16 corner
80	31	Intersect 6 m West of 1/4 Sec cor set Sec 5 & 8

1889

Township 3 South

Range 39 East

Union County, Oregon.

CHAINS. LKS.

Fence South through Sec 8

- 20 07 Set Stake for center N 1/2 Sec 8
- 40 14 The center Sec 8 a Stone 6 x 12 x 18
- 60 22 The center S 1/2 Sec 8
- 80 31 The 1/4 Sec cor bet Sec 8 & 17

The 1/8 corner on South Boundary S W 1/4 Sec 8
Thence East bet Sec 8 & 17

Var 20° E

- 19 9 1/2 The 1/4 Sec Cor bet Sec 8 & 17
a Stone 6 x 6 x 22

Thence East

- 39 82 The Corner to Sec 8 = 9 = 16 & 17

Thence West

- 19 9 1/2 Set Stone 4 x 9 x 22 for 1/8 corner

- 39 82 The 1/4 Sec cor bet Sec 8 & 17

The 1/8 Corner on West Boundary N W 1/4 Sec 8
Thence East through N 1/2 Sec 8

Var 20° E

- 20 00 Set Temporary 1/16 corner
- 40 20 Intersect N & S line 5 lks South of center N 1/2
- 52 20 Set Temporary Fractional Corner bet Oliver & Stone
- 60 20 Set Temporary 1/16 corner
- 80 46 The 1/8 corner on East Boundary N E 1/4 Sec 8
Thence West through N 1/2 Sec 8

- 20 13 Set Stone 8 x 12 x 28 for 1/16 cor in Center N E 1/4 Sec 8
- 28 19 Set Stone 7 x 7 x 25 for Fractional Corner bet Oliver & Stone
- 40 26 The center N 1/2 Sec 8 a Stone 8 x 10 x 15
- 60 39 Set Stone 6 x 12 x 20 for 1/16 cor in Center N W 1/4 Sec 8
- 80 46 The 1/8 corner on W Bdy N W 1/4 Sec 8

The center E 1/2 Sec 8 Thence North

- 40 15 The 1/8 corner on South Bdy S E 1/4 Sec 8 Thence North

- 20 07 1/2 Set Stone 5 x 6 x 22 for 1/16 cor in Center S E 1/4 Sec 8

The 1/8 corner on South Boundary S W 1/4 Sec 8 Thence North

- 40 17 The center W 1/2 Sec 8 Thence South

- 20 08 1/2 Set Stone 6 x 12 x 20 for 1/16 corner in Center S W 1/4 Sec 8