

420  
1889

RECORD OF SURVEY

No 100

Township 5 South Range 40 East W. M. Union County, Oregon.

CHAINS. LKS.

J. E. Yowell

Nov. the 25<sup>th</sup> 1889

I Commenced at the corner to  
Sec 7=18=12 & 13 on Guide  
Meridian bet. Ranges 39 & 40 East  
Thence East bet Sec 7 & 18  
Var 20° E

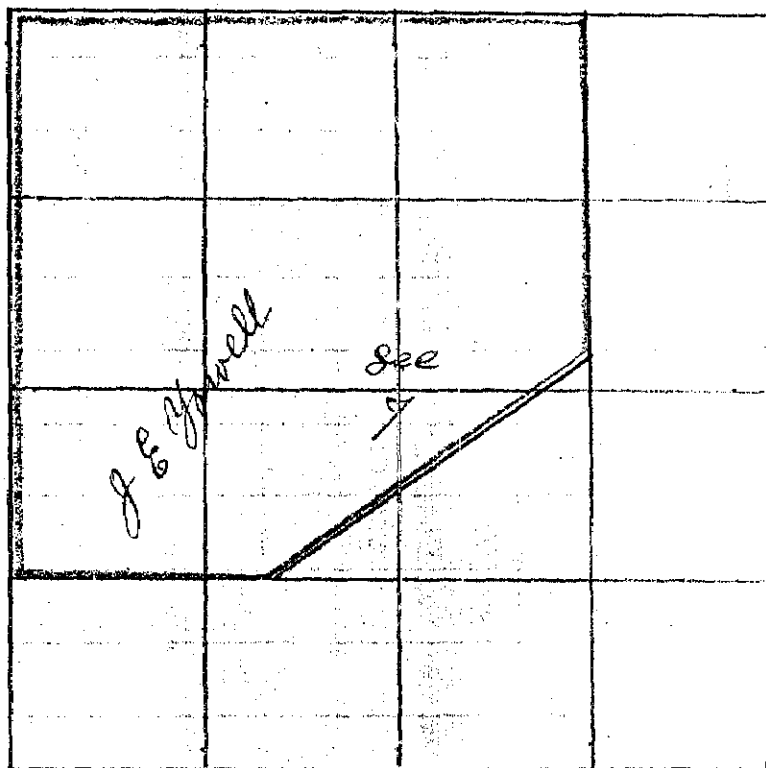

39 00 Rail Road Course S. E. 1/4, N. W. 1/4

40 10 Set Temporary 1/4 Sec. corner

60 15 Set Temporary 1/8 corner

80 20 found no corner

Set Temporary Cor to Sec. 7=8=17 & 18

Thence East bet Sec 8 & 17

39 75 Intersect 70 lks South of 1/4 Sec corner bet Sec 8 & 17

Thence S 89° 40' W on True line bet Sec 8 & 17

39 79 Set Stone 6 x 9 x 16 for corner to Sec 7=8=17 & 18

Thence West bet Sec 7 & 18

20 04 Set Post for 1/8 corner

40 08 Set Stone 6 x 11 x 22 for 1/4 Sec corner bet Sec 7 & 18

80 17 The corner to Sec 7=18=12 & 13.

The 1/4 Sec corner bet. Sec 17 & 18

Thence North bet Sec 17 & 18

Var 20° E

39 98 The corner to Sec 7=8=17 & 18

Thence North bet Sec 7 & 8

Var 20° E

20 10 Set Temporary 1/8 corner

40 07 Set Temporary 1/4 Sec. cor

79 90 Intersect 54 lks East of corner to Sec 5=6=7 & 8

Thence S 23° E on True line bet Sec 7 & 8

39 97 Set Stone 6 x 6 x 48 in mound of Stone

for 1/4 Sec corner bet Sec 7 & 8

from which

a Stone in place 4 feet wide at base and 3 feet high  
bears S 62° E 13 lks dist.

59 94 Set Stone in mound of Stone for 1/8 cor

79 93 The corner to Sec 7=8=17 & 18

Thence South

39 97 The 1/4 Sec corner bet Sec 17 & 18

Township 5 South Range 40 East Union County, Oregon.

The 1/4 Sec corner bet Sec 7 & 8  
 Thence West through Sec 7  
 Var 20° E

20 50 Set Temporary 1/16 corner  
 40 50 Set Temporary center Sec 7  
 71 53 Rail Road course S E & N W  
 80 84 1/2 intersect - 14 lks South of 1/4 Sec corner bet Sec. 7 & 12  
 Thence S 89° 54' E on True line through Sec 7  
 40 57 center Sec 7  
 60 70 Set Stone 6 x 10 x 25 in Mound of Stone for 1/16 cor in center S 1/2 Sec 7  
 80 84 The 1/4 Sec corner bet Sec 7 & 8 -

The 1/4 Sec corner bet Sec 7 & 12  
 Thence North through Sec 7  
 Var 20° E

20 50 Set Temporary 1/16 corner  
 40 07 Intersect True E & W line 5 lks East of Center  
 80 50 Intersect 10 lks East of 1/4 Sec corner bet Sec 6 & 7  
 Thence South  
 40 43 The Center Sec 7  
 60 46 1/2 Set Stone 3 x 4 x 18 for 1/16 corner in Center S 1/2 Sec 7  
 80 50 The 1/4 Sec corner bet Sec 7 & 18

The 1/4 Sec corner bet Sec 7 & 12 on Guide Meridian  
 Thence South bet Sec 7 & 12

40 58 The corner to Sec 7 = 12 = 12 & 13  
 Thence North

20 29 Set Stone in Mound of Stone for 1/4 corner  
 Thence East through S 1/2 Sec 7

19 50 Rail Road S E & N W  
 40 33 center S 1/2 Sec 7  
 The 1/16 corner in Center S 1/2 Sec 7 Thence North Var 20° E

39 93 The 1/2 corner on South boundary S E 1/4 Sec 7  
 Thence North

19 96 Set Stone 5 x 10 x 18 for 1/16 corner in Center S E 1/4 Sec 7  
 Thence North 94 3/4 Rods Set Stone 7 x 10 x 32 in Mound of Stone  
 Thence S 55° W 166 1/4 Rods Set Stone 7 x 10 x 23 for fractional corner  
 Thence East 136 Rods to Place of Beginning the Center S E 1/4

J. W. Kimball County Surveyor