

RECORD OF SURVEY

No 168

Township s 8 and 9 South Range 45 East Union County, Oregon.

A N Young et al Done Sept 3<sup>rd</sup> 4<sup>th</sup> 1892  
T. 8, South Range 45 East

CHAINS. LKS.

84 0.8 This Survey was commenced at the 1/4 Sec corner between Secs 28 & 33. Thence S Var 21° 15' E intersected the 1/4 Sec corner on the S Bdy of Sec 33.

Thence East  
40 0.0 found no Sec corner  
From the 1/4 Sec corner on the N Bdy of Sec 33 East

40 0.0 found Sec corner between Secs 27+28+33 & 34  
Thence South

40 0.0 found 1/4 Sec corner between 33 & 34  
From the Sec corner between Secs 28 & 29 & 32 & 33 South

40 0.0 found no 1/4 corner. Therefore established a 1/4 corner between Sec 32 & 33 it being a Rock 10 x 12 x 18 in a mound of Rock

I then run a line from the 1/4 corner on the East Bdy of Sec 33 to the 1/4 corner established on the West Bdy of Sec 33 and intersected the line run N & South  
39 5.0 from the 1/4 Sec corner on the N Bdy of Sec 33 and set Rock for Centre of Section 8 x 10 x 15 in mound of Rock

Thence West  
Var 22° 15' 20090' E

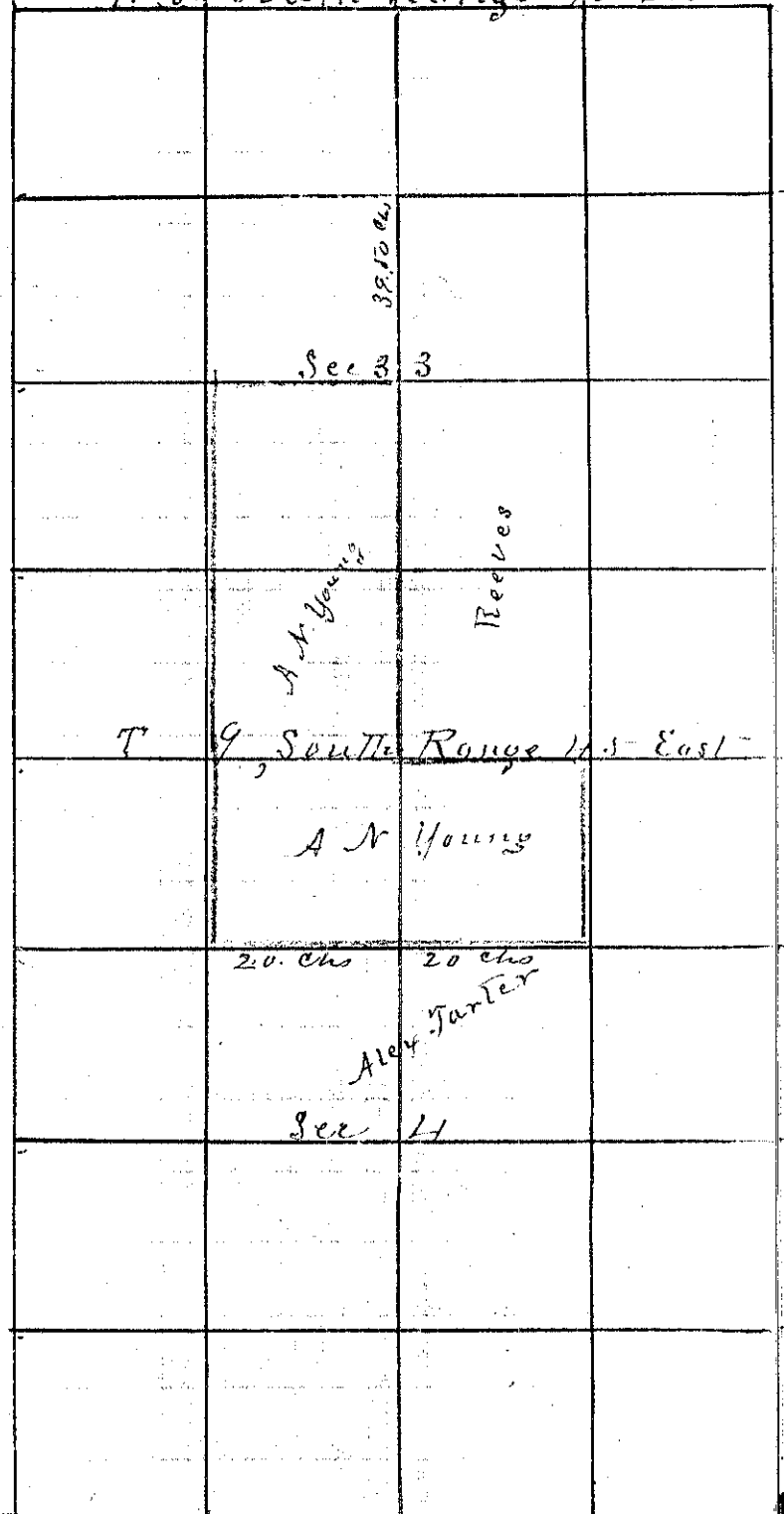

J L Croles  
County Surveyor